

BOXER-6842M

Fanless Embedded Controller with 8th/9th Generation Intel® Processor

BOXER-6842M-A2/A3

Front View

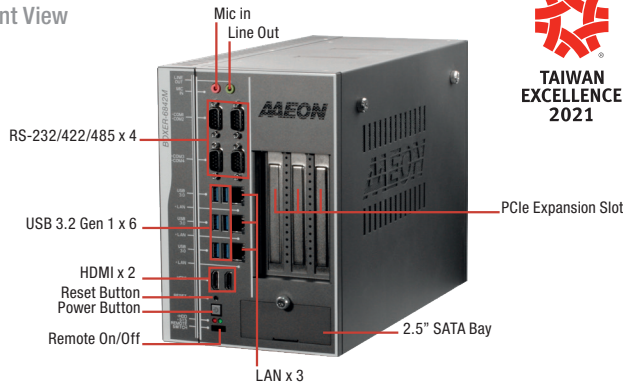

Rear View

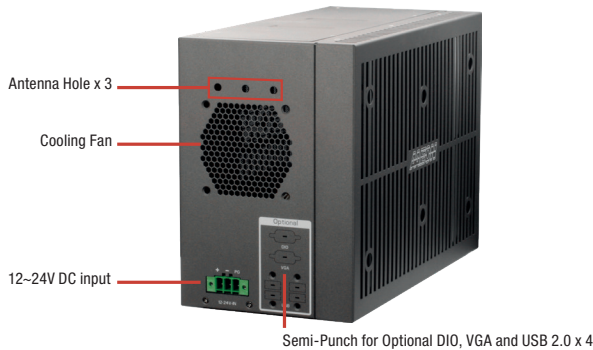

BOXER-6842M-A4

Front View



Rear View



Features

- High Computing Power
- Intel® Coffee Lake-S LGA 1151 Desktop Processor
- HDMI x 2 for Dual Display
- Support C246 PCH
- Support PCIe x16 + PCIe x4 / 2PCIe x8 (in x16 slot) + PCIe x4
- Single Power Input (for both System & one Graphics Card)
- Fanless System (A3) or Fan System with PWM function (A2/A4)
- Support dual Graphics Cards with Two Power Inputs (A4)



I/O	HDMI x 2 Audio (Mic-in, Line-out) USB 3.2 Gen1 x 6 DB-9 x4 for RS-232/422/485 with automatic flow control 3 pin DC Power input x 1 (+, -, GND) Power ON/OFF switch x 1 2 pin Remote power on/off connector Reset switch
Expansion	A2 Full-size Minicard x 1 (PCIe + USB with 1 SIM Slot) Half-size Minicard x 1 (PCIe + USB, optional for mSATA) M.2 M key (2280) x 1 (PCIe x4) PCIe [x4] x 1 PCIe [x16] x 1 - Max. Power Consumption of GPU card 250W - Max. Size of GPU card 280mm x150mm x 40mm A3 Full-size Minicard x1 (PCIe + USB with 1 SIM Slot) Half-size Minicard x1 (PCIe + USB, optional for mSATA) M.2 M key (2280) x1 (PCIe x4) PCIe [x4] x1 PCIe [x8] (in x16 slot) x 2 A4 Full-size Minicard x1 (PCIe + USB with 1 SIM Slot) Half-size Minicard x1 (PCIe + USB, optional for mSATA) M.2 M key (2280) x1 (PCIe x4) PCIe [x4] x1 PCIe [x8] (in x16 slot) x2 Support dual Graphics Cards with two power inputs - Max. Power Consumption of GPU card 250W x2 - Max. Size of GPU card 280mm x150mm x 40mm Note: A3 is fanless system. A2 & A4 is fan system with PWM function (Recommend for users need install GPU card).
Reserved Connector	Internal, SATA x 2; Internal, 8bit DIO x 1; Internal, USB 2.0 x 4; Internal, LPC x 1; Internal, Secondary System Fan Connector x 1
Indicator	System Power LED x 1 (Green), Storage Active LED x 1 (Red)
OS Support	Windows® 10 Enterprise 64 bit, Ubuntu 18.04.4
Power Supply	
Power Requirement	A2/A3/A4 DC In 12-24V with 3-pin terminal block No Graphics Card: CPU 35W->120W Adapter x 1, CPU 71W->240W Adapter x 1 With 250W Graphics Card x1: 480W Adapter x 1 A4 DC In 12-24V with 3-pin terminal block With 250W Graphics Card x2: 330W Adapter x 1 + 480W Adapter x 1
Mechanical	
Mounting	Wallmount
Dimensions (W x H x D)	A2/A3: 6.17" x 8.92" x 12.8" (156.7mm x 226.5mm x 325mm) A4: 7.77" x 8.92" x 12.8" (197.3mm x 226.5mm x 325mm)
Gross Weight	A2/A3: 18.52 lb (8.4 Kg) A4: 20.72 lb (9.4 Kg)
Net Weight	A2/A3: 15.65 lb (7.1 Kg) A4: 17.66 lb (8.1 Kg)
Environmental	
Operating Temperature	Without Graphics Cards: -4°F ~ 149°F (-20°C ~ 65°C) with 0.5m/s airflow With 250W Graphics Card: 32°F ~ 113°F (0°C ~ 45°C) with 0.5m/s airflow
Storage Temperature	-49°F ~ 176°F (-45°C ~ 80°C)
Storage Humidity	5 ~ 95% @ 40°C, non-condensing
Anti-Vibration	HDD: Random, 1Grms, 5-500Hz
Certification	CE / FCC class A

Specifications

System	
CPU	Intel® Xeon® E-2124G; Intel® Core™ i9-9900T; Intel® Core™ i7-8700T; Intel® Core™ i5-8500T; Intel® Core™ i3-8100T; Intel® Pentium® G5400T; Intel® Celeron® G4900T Note: Support max. TPD 71W Processor
Chipset	C246, No H310 downward support
System Memory	DDR4 SO-DIMM socket x4 (double deck) Support max. 2666MHz up to 128GB Support un-buffered and ECC / non-ECC type SODIMM
Display Interface	HDMI x 2 Support Dual Independent Display, 4K Ultra HD displays
Storage Device	2.5" SATA Drive Bay x2 (4 SATA Port w/ RAID Function) mSATA x 1 (optional) M.2 2280 NVMe SSD slot x 1
Ethernet	RJ-45 x 3 for GbE (Intel i211AT x 2, i219LM x 1)

Dimension

Unit: mm

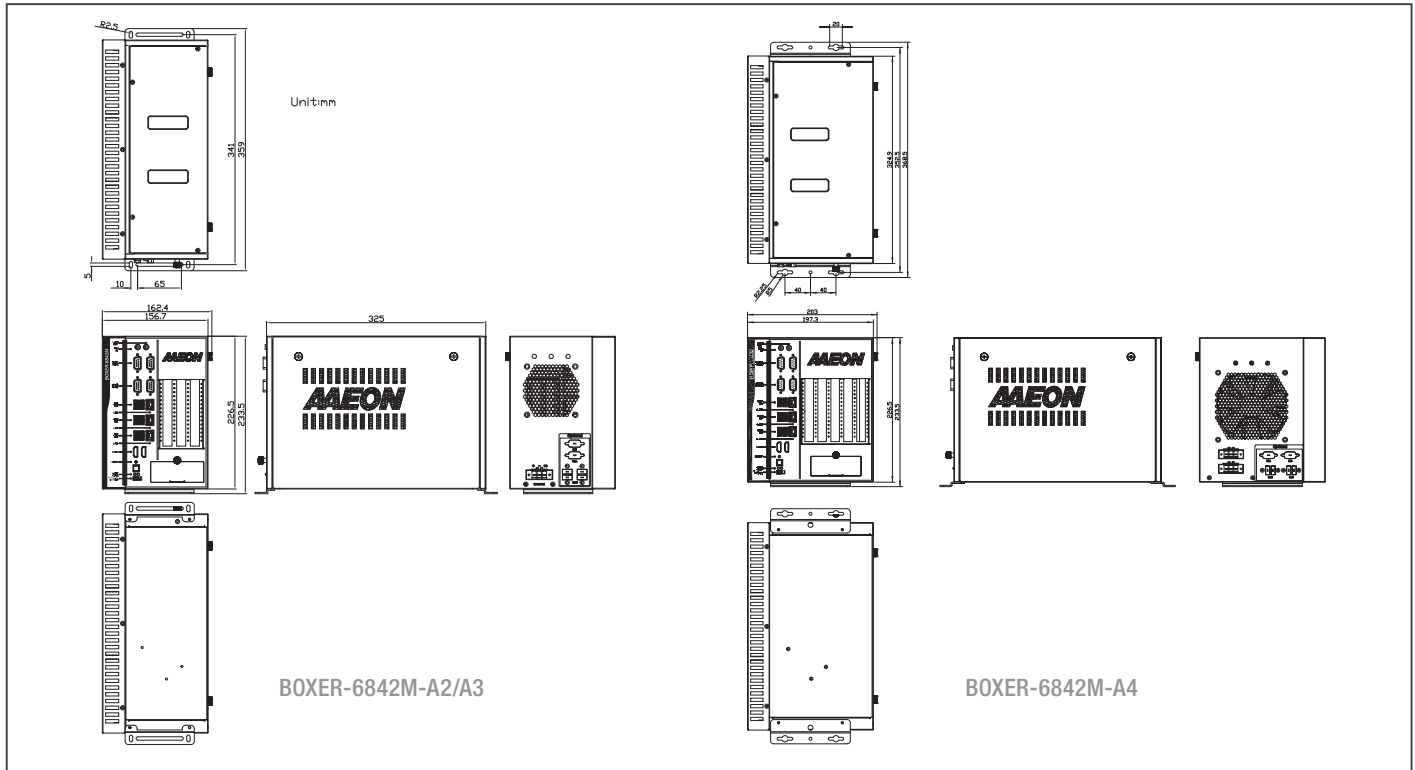

BOXER-6842M-A2/A3

BOXER-6842M-A4

Ordering Information

Part Number	CPU	PCH	LAN	Fan	USB 3.2 Gen1	RS-232/422/485	RS-232	Digital I/O	Audio	Storage	Display	Expansion	Mounting	Power	Operation temp.
BOXER-6842M-A2-1010	—	C246	3	Fan System	6	4	—	—	Mic-in Line-out x 1	2.5" SATA Drive bay x 2 mSATA x 1 (optional) M.2 2280 NVMe SSD slot x 1	HDMI x 2	Full-size Minicard x 1, Half-size Minicard x 1, M.2 M key (2280) x 1, PCIe [x4] x 1, PCIe [x16] x 1	Wallmount	DC In 12-24V with 3-pin terminal block	-20°C ~ 65°C with 0.5m/s airflow
BOXER-6842M-A3-1010	—	C246	3	Fanless System	6	4	—	—	Mic-in Line-out x 1	2.5" SATA Drive bay x 2 mSATA x 1 (optional) M.2 2280 NVMe SSD slot x 1	HDMI x 2	Full-size Minicard x 1, Half-size Minicard x 1, M.2 M key (2280) x 1, PCIe [x4] x 1, PCIe [x8] x 2 (in x16 slot)	Wallmount	DC In 12-24V with 3-pin terminal block	-20°C ~ 65°C with 0.5m/s airflow
BOXER-6842M-A4-1010	—	C246	3	Fan System	6	4	—	—	Mic-in Line-out x 1	2.5" SATA Drive bay x 2 mSATA x 1 (optional) M.2 2280 NVMe SSD slot x 1	HDMI x 2	Full-size Minicard x 1, Half-size Minicard x 1, M.2 M key (2280) x 1, PCIe [x4] x 1, PCIe [x8] x 2 (in x16 slot)	Wallmount	DC In 12-24V with 3-pin terminal block	-20°C ~ 65°C with 0.5m/s airflow

Packing List

- Wallmount Bracket x 2
- 3 Pin DC-in Power Connector x 1
- Screw Package x 1
- Thermal Pad Package x 1
- BOXER-6842M

Optional Accessories

- **1255901209**
120W Power Adapter
- **1255902400**
240W Power Adapter
- **1255903300**
330W Power Adapter
- **1702031802**
Power Cord (US type)
- **1702031803**
Power Cord (European Type)
- **170203180E**
Power Cord (Japanese Type)
- **9741238H00**
WiFi Module & Antenna
- **9741EG25G0**
4G Module & Antenna (for global)
- **9741EC25A0**
4G Module & Antenna (for USA-AT&T)
- **9741EC25V0**
4G Module & Antenna (for USA-Verizon)
- **9697T60101-D**
Riser card with 1 PCIe x 16 + 1 PCIe x 4
- **9697T62100-D**
Riser card with 2PCIe x 8 (in x 16 slot) +1PCIe x 4
- **1255X00021**
480W Power Adapter (DIN Rail)